



euroscreen® Diplomat Flex

SCREEN SURFACES



FlexWhite

Pliable matt white front surface, superb colour rendition, Full HD compliant. discreetly seamed. Gain 1.0.

PROJECTION FORMATS

1:1

The screen format is 1:1.
No black borders.

4:3

NO BLACK BORDERS

The screen format is 4:3.
No black borders.

CONTROL OPTIONS



Installation

3m cable. Needs to be installed by electrician.

Diplomat Flex is a very robust high quality screen in large sizes. The installation is very flexible with mounting brackets that can be adjusted sideways to preferred positions. The screen can be mounted on the wall as well as in the ceiling. It comes in a white aluminium case and with three meter cable. Due to the thin screen surface used, the screen becomes very slim in it's appearance even in sizes up to 6m wide. The surface is welded either horizontally or vertically to match desired formats and sizes, leaving an almost invisible weld and screen surface presents great surface flatness.

SCREEN DIMENSIONS

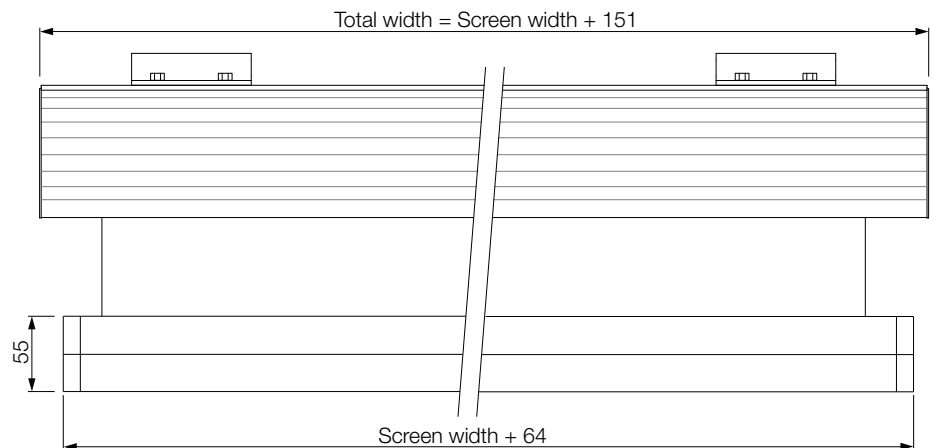

Example – Diplomat Flex

Model: MF4030

Screen width: 4000 mm

Total width: 4000 mm + 151 mm = 4151 mm

Bar width: 4000 mm + 64 mm = 4064 mm

CASE DIMENSIONS

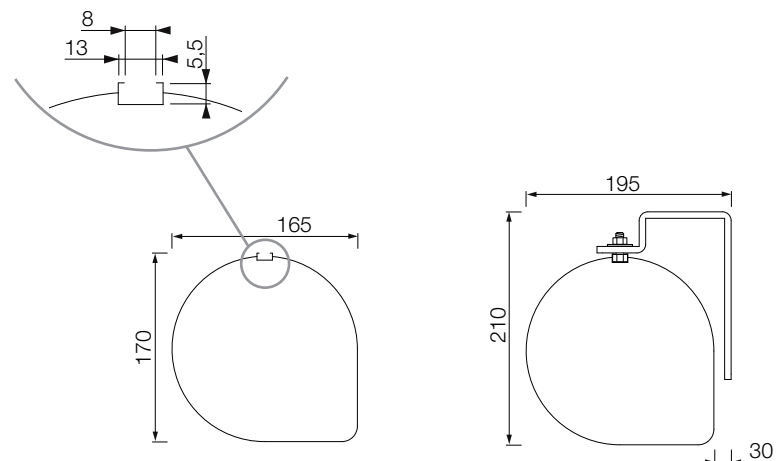

ELECTRICAL SPECIFICATIONS

Motor Specifications

Voltage: 220 V Frequency: 50 Hz
 Power: 121 W Momentum: 6Nm
 Speed: 28 rpm Protection: IP44

The motor is grounded.

Cable Specifications

Thickness: \varnothing 7 mm
 Cable area: 4x0,5mm² , motor to control
 3x0,75mm² , control to plug

Wires: Black - Up
 Brown - Down
 Blue - Neutral
 Green/Yellow - Ground

Installation cable

Part no: 210673
 Enclosed with the screen.
 Weight: 0.40kg

BRACKET DIMENSIONS

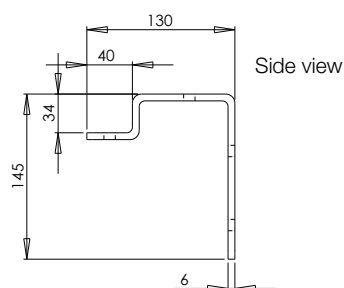

Side view

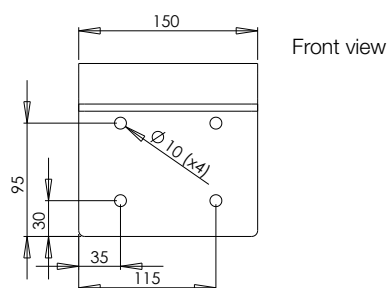

Front view

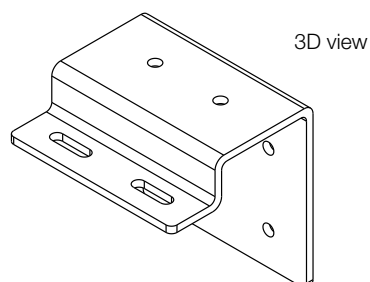

3D view

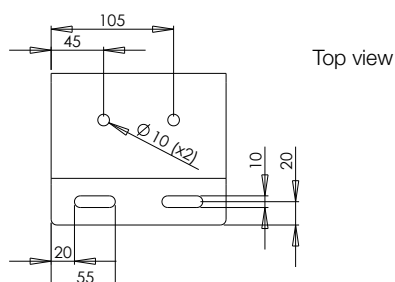

Top view

PACKAGING DIMENSIONS

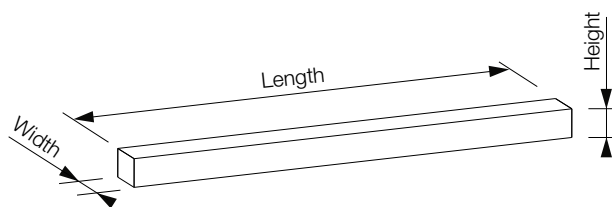

Screen width	Box length	Box width	Box height
3000	3330	255	260
3500	3830	255	260
4000	4330	255	260
4500	4830	255	260